

SCALE 100 PERCHES TO AN INCH

TRAVERSE UP THE RIVER

- 1. N: 80° E: 16 Perches
 - 2. N: 86° E: 46 ps
 - 3. N: 62° E: 46 ps
 - 4. N: 55° E: 34 ps
 - 5. N: 60° E: 34 ps
 - 6. N: 35° E: 60 ps
 - 7. N: 65° E: 20 ps
 - 8. N: 45° E: 24 ps
 - 9. N: 57° E: 20 ps
 - 10. N: 71° E: 30 ps
- 330

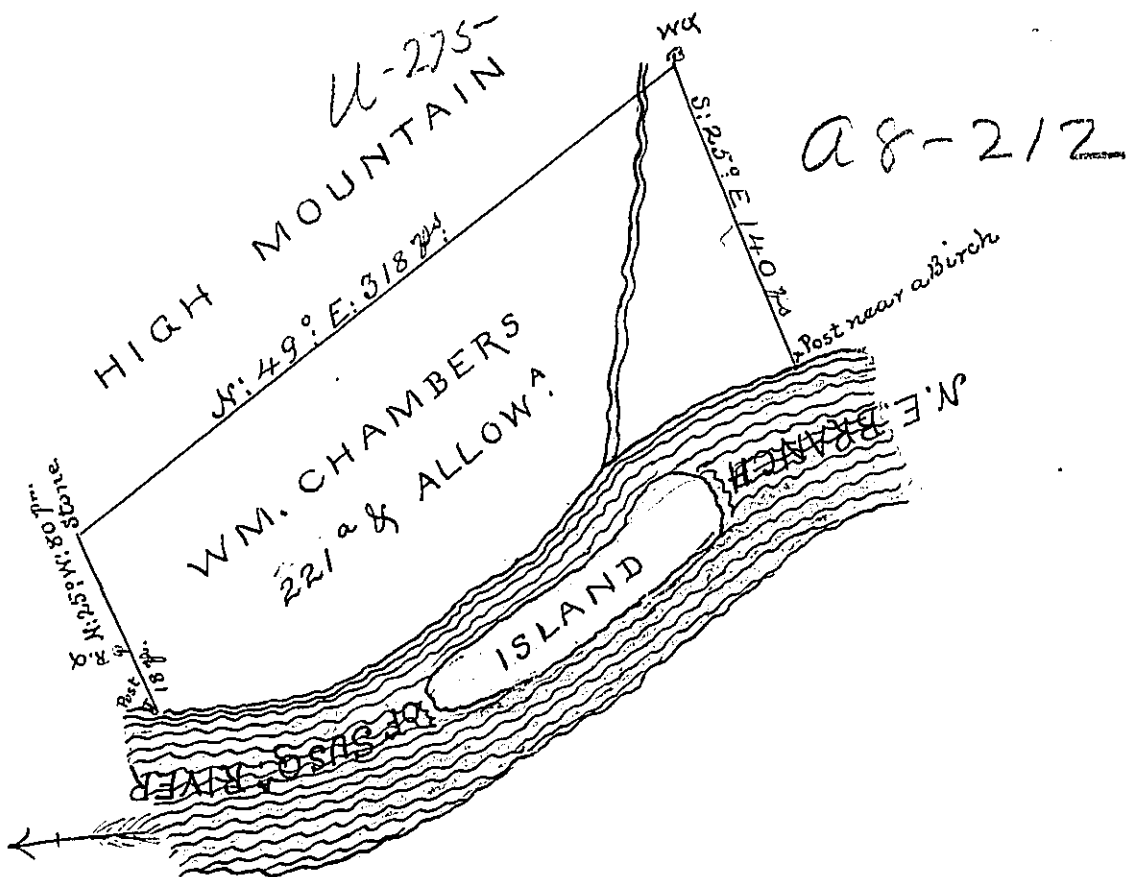

A Draught of a Tract of Land called Chambersburgh Situate on the West Side of the North East branch of Susquehanna River a little below the Whining Falls in said River also below the Honorable The Proprietaries manor of Sunbury in Northampton County containing Two hundred and twenty one Acres besides the usual allowance of 6. p Cent for Roads Surveyed for William Chambers the 20th May 1769 In Pursuance of an order dated the 3^d day of April 1769 Number 104

by Chas. Stewart Dep Sur.

To
John Lukens Esq.
Survey General

IN TESTIMONY that the above is a copy of the original remaining on file in the Department of Internal Affairs of Pennsylvania, made conformably to an Act of Assembly approved the 16th day of February, 1833, I have hereunto set my Hand and caused the Seal of said Department to be affixed at Harrisburg, this eighteenth day of October 1873.

J. Simpson Africa,
Secretary of Internal Affairs